MELBOURNE CITYLINK PROJECT

ADVERTISING SIGN LOCATIONS

NOVEMBER 2003

TABLE 1

MELBOURNE CITY LINK PROJECT ADVERTISING SIGN LOCATIONS - NOVEMBER, 2003

| Location No | Location | Sign Type | Maximum No of Faces | Maximum Height of Structure (m) | Dimension (m) | Expiry Date |
|-------------|---|-----------|---------------------|---------------------------------|---------------|-------------------|
| 1 | Located between 40 and 90 metres north of Macaulay Road and 60 metres east of Stubbs Street, Flemington. | Pole | 2 | 7 | 19 x 4.5 | Concession Period |
| 2 | Adjoining Moonee Ponds Creek. Approximately 10 metres south of Arden Street and approximately 120 metres east of Lloyd Street, Nth Melbourne. | Pole | 2 | 7 | 19 x 4.5 | Concession Period |
| 3 | Located between 10 and 20 metres west of the Western Link outbound ramp and between 140 and 160 metres north of Dynon Road | Pole | 2 | 7 | 19 x 4.5 | Concession Period |
| 4 | Signs located over Dynon Road on eastern side of Western Link and western side of outbound ramp. | Bridge | 2 | — | 22.8 x 2.6 | Concession Period |
| 5 | Located between 200 and 300 metres south of Dynon Road and approximately 10 metres west of Western Link. | Pole | 2 | 7 | 19 x 4.5 | Concession Period |
| 6 | Approximately 160 metres west of Moonee Ponds Creek and between 100 and 200 metres north of Footscray Road, Footscray. | Pole | 2 | 7 | 19 x 4.5 | Concession Period |
| 7 | Located between 20 and 40 metres west of Moonee Ponds Creek and between 40 and 60 metres north of Footscray Road, Footscray. | Pole | 2 | 6 | 19 x 4.5 | Concession Period |
| 8 | Signs located over Footscray Road on eastern side of Western Link and western side of outbound ramp. | Bridge | 2 | — | 22.8 x 2.6 | Concession Period |
| 9 | Located between 150 and 230 metres south of Footscray Road and approximately 50 metres west of Moonee Ponds Creek, Melbourne. | Pole | 2 | 7 | 19 x 4.5 | Concession Period |
| 10 | Located between 100 and 120 metres east of Thackray Street and approximately 10 metres south of Westgate Freeway. | Pole | 2 | 13 | 19 x 4.5 | Concession Period |
| 11 | Signs located on Graham Street Bridge. | Bridge | 2 | — | 22.8 x 2.6 | Concession Period |
| 12 | Signs located on Ingles Street Bridge. | Bridge | 2 | — | 22.8 x 2.6 | 31 December, 2013 |
| 13 | Gantry over Westgate Freeway located between 50 and 100 metres east of White Street, Port Melbourne. | Gantry | 2 | 7 | 19 x 4.5 | 31 December, 2013 |
| 14 | Sign located on south face of Westgate Freeway approximately 10 metres east of the eastern alignment of Kingsway. | Bridge | 1 | — | 22.8 x 2.6 | 31 December, 2013 |
| 15 | Signs located on Cremorne Railway Bridge over Southern Link. | Bridge | 2 | — | 22.8 x 2.6 | Concession Period |

TABLE 1

MELBOURNE CITY LINK PROJECT ADVERTISING SIGN LOCATIONS - NOVEMBER, 2003

| Location No | Location | Sign Type | Maximum No of Faces | Maximum Height of Structure (m) | Dimension (m) | Expiry Date |
|-------------|---|-----------|---------------------|---------------------------------|---------------|-------------------|
| 16 | Located outside McConchie Reserve approximately 90 metres east of Mary Street and approximately 20 metres north of the Southern Link. | Low Level | 1 | 2* | 19 x 4.5 | 31 December, 2013 |
| 17 | Located between 140 and 170 metres west of Burnley Street and between 30 and 50 metres south of Barkley Avenue, Burnley. | Pole | 2 | 7 | 19 x 4.5 | Concession Period |
| 18 | Located between Gibdon Street Ramp and South Eastern Freeway, approximately 60 metres east of Stawell Street, Burnley. | Low Level | 1 | 1* | 19 x 4.5 | 31 December, 2013 |
| 19 | Signs located on Gibdon Street Bridge. | Bridge | 2 | — | 22.8 x 2.6 | Concession Period |
| 20 | Signs located on Yarra Boulevard Bridge. | Bridge | 2 | — | 22.8 x 2.6 | Concession Period |
| 21 | Approximately 580 metres south-east of Loyola Grove and 10 metres south of Richmond Golf Course. | Low Level | 2 | 2* | 19 x 4.5 | 31 December, 2013 |
| 22 | Signs located on Heyington Railway Bridge over Southern Link, Burnley. | Bridge | 2 | — | 22.8 x 2.6 | Concession Period |
| 23 | Signs located on St Kevins' property approximately 10 metres west of Moonga Street and 15 metres south of the Southern Link. | Pole | 2 | 7 | 19 x 4.5 | 31 December, 2013 |

Notes:

- 'Pole' indicates advertising sign(s) on freestanding pole structure.
- 'Bridge' indicates advertising sign(s) are located on bridges and are contained with the bridge structure unless otherwise agreed by the MCLA.
- Unless otherwise stated, Height of Structure is the maximum height of the advertising sign above the road surface in metres. The Height of Structure is measured from the top of the adjacent carriageway to the underside of the structure (comprising the sign face as nominated and 700mm undercladding).
- Maximum No of Faces refers to the maximum number of advertising signs located on the referenced structure.
- Height of Structure shown * are measured from ground level to the underside of the structure.
- The location of a sign may be varied with the approval of the Minister having regard to site conditions, traffic or road safety considerations.
- Precise locations to be noted on development plans submitted to the MCLA.
- A sign must not emit light or glare which spills directly on to adjacent land so as to cause a material loss of amenity to the occupier of that land.

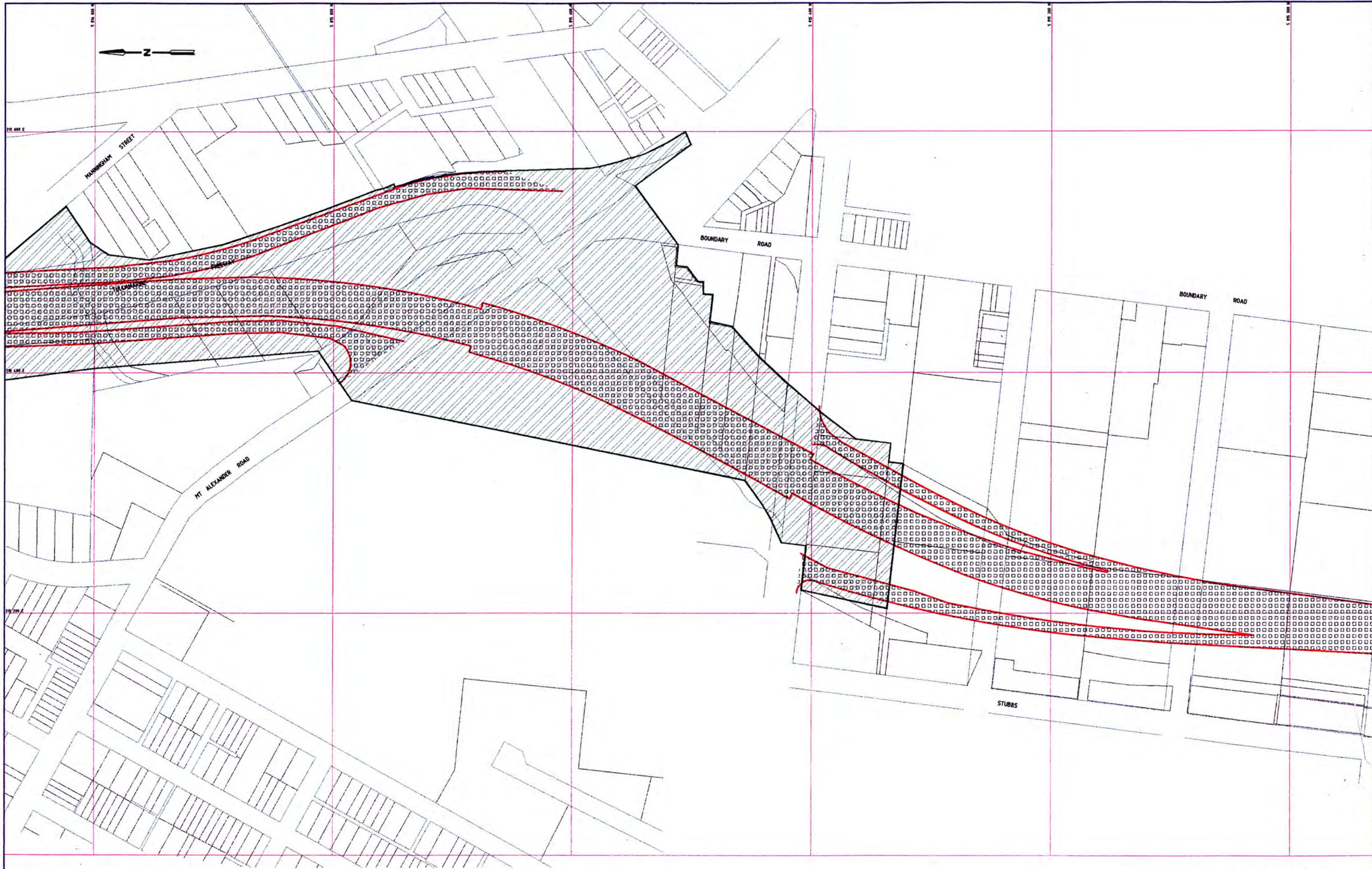

LEGEND

- FREEWAY
- MELBOURNE CITY LINK
- PROHIBITED AREA FOR ADVERTISING SIGNS
- DOT REPRESENTS APPROXIMATE ADVERTISING SIGN LOCATIONS.

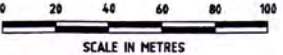

| REV | DATE | DESCRIPTION | BY | APP | REV | DATE | DESCRIPTION | BY | APP | REV | DATE | DESCRIPTION | BY | APP | REV | DATE | DESCRIPTION |
|-----|----------|---|----|-----|-----|------|-------------|----|-----|-----|------|-------------|----|-----|-----|------|-------------|
| A | 03.07.98 | ISSUED FOR INFORMATION | | | | | | | | | | | | | | | |
| B | 31.07.98 | PROHIBITED AREAS & ADVERTISING SIGN NO.'S REVISED | | | | | | | | | | | | | | | |
| C | 25.08.98 | PROJECT BOUNDARY REVISED & HATCHED AREAS REVISED | | | | | | | | | | | | | | | |

Transfield

OBAYASHI

Transfield-Obayashi Joint Venture

| | | |
|----------------|---------------|----------|
| DESIGNER | DESIGN NUMBER | FILE |
| RGP | APPROVED LPP | |
| NS | DATE | 03.07.98 |
| SCALE AS SHOWN | CAD FILE | CLZ5005 |

MELBOURNE CITY LINK PROJECT

CITY LINK

ADVERTISING SCHEDULE

SHEET 1 OF 14

MCL/ZZ 5005

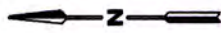
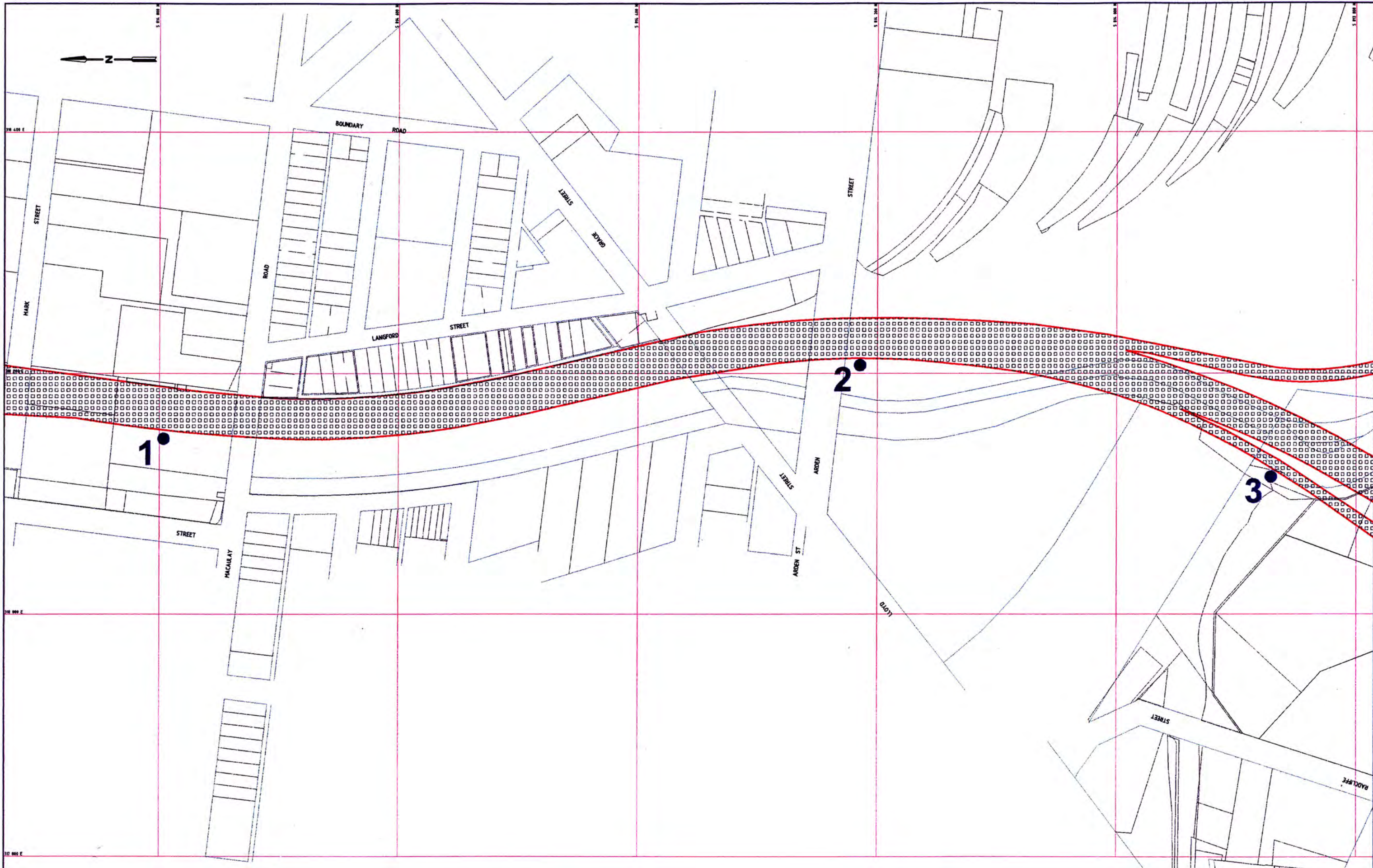

LEGEND

- FREEWAY**
- MELBOURNE CITY LINK**
- PROHIBITED AREA FOR ADVERTISING SIGNS**
- DOT REPRESENTS APPROXIMATE ADVERTISING SIGN LOCATIONS.**

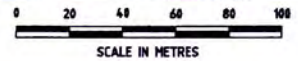

| REV | DATE | DESCRIPTION | APP'D | REV | DATE | DESCRIPTION | APP'D | REV | DATE | DESCRIPTION | APP'D | REV | DATE | DESCRIPTION | APP'D | REV | DATE | DESCRIPTION |
|-----|----------|--|-------|-----|------|-------------|-------|-----|------|-------------|-------|-----|------|-------------|-------|-----|------|-------------|
| A | 20.04.09 | ISSUED FOR INFORMATION | RSP | LFP | | | | | | | | | | | | | | |
| B | 21.04.09 | PROJECT BOUNDARY REVISED & HATCHED AREAS REVISED | RSP | LFP | | | | | | | | | | | | | | |



| NO. | DESCRIPTION | DATE |
|-----|--|----------|
| 1 | ISSUED FOR INFORMATION | 20.04.09 |
| 2 | PROJECT BOUNDARY REVISED & HATCHED AREAS REVISED | 21.04.09 |

MELBOURNE CITY LINK PROJECT
CITY LINK
ADVERTISING SCHEDULE
SHEET 2 OF 14

SCALE: AS SHOWN
 DRAWING NO: CLZ2585
 SHEET NO: MCL/ZZ 5006

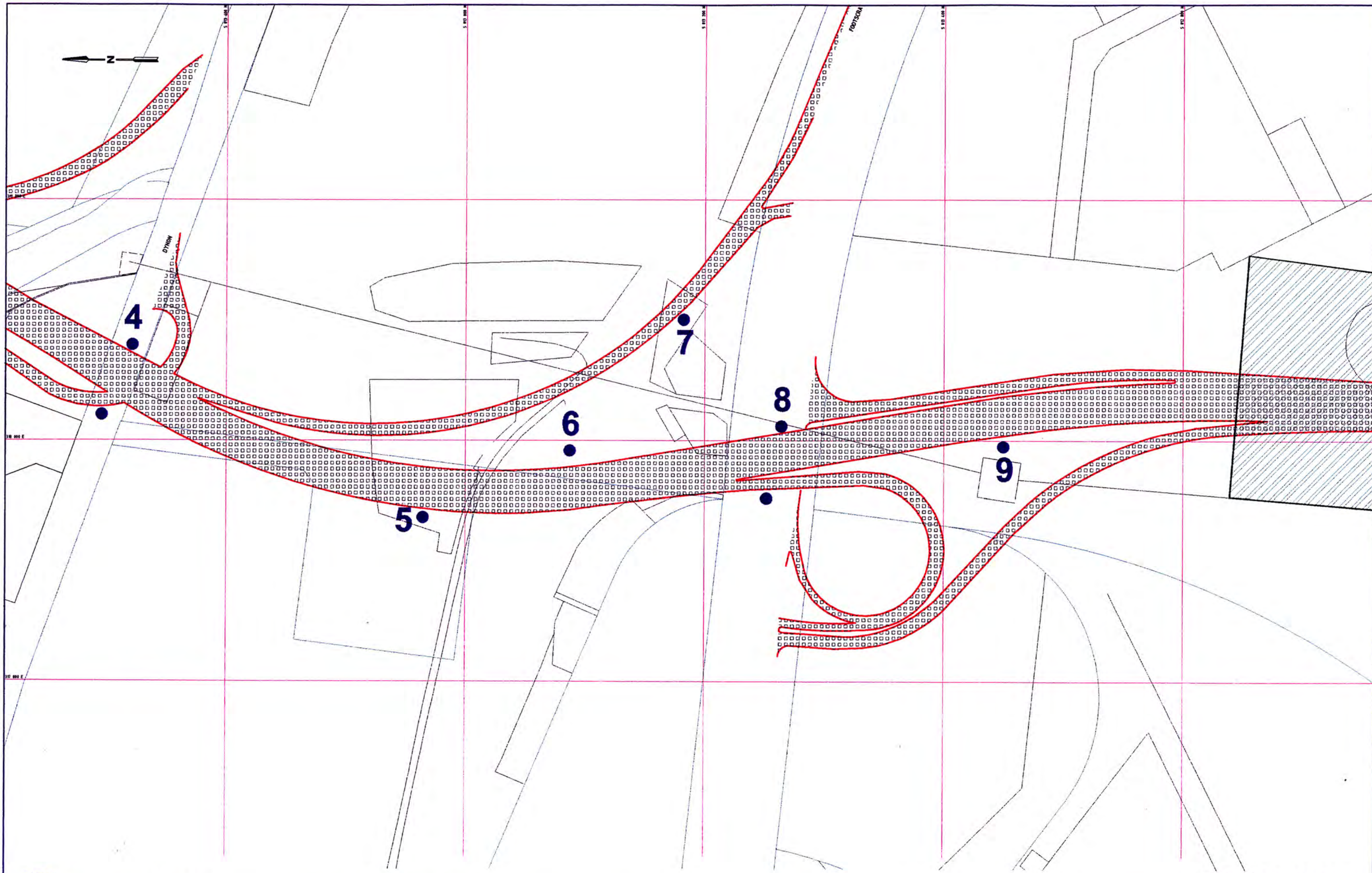

LEGEND

- FREEWAY
- MELBOURNE CITY LINK
- PROHIBITED AREA FOR ADVERTISING SIGNS
- DOT REPRESENTS APPROXIMATE ADVERTISING SIGN LOCATIONS.

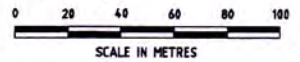

| REV | DATE | DESCRIPTION | DRW | APP | REV | DATE | DESCRIPTION | DRW | APP | REV | DATE | DESCRIPTION | DRW | APP | REV | DATE | DESCRIPTION |
|-----|----------|---|-----|-----|-----|------|-------------|-----|-----|-----|------|-------------|-----|-----|-----|------|-------------|
| A | 03.07.98 | ISSUED FOR INFORMATION | | | | | | | | | | | | | | | |
| B | 31.07.98 | PROHIBITED AREAS & ADVERTISING SIGN NO.'S REVISED | REP | LPP | | | | | | | | | | | | | |
| C | 29.08.98 | PROJECT BOUNDARY REMOVED & HATCHED AREAS REVISED | REP | LPP | | | | | | | | | | | | | |



| DESIGN | DESIGN PARAMETER | TITLE |
|-------------------|----------------------|---|
| DRAWN REP | APPROVED LPP | MELBOURNE CITY LINK PROJECT CITY LINK ADVERTISING SCHEDULE SHEET 3 OF 14 |
| CHECKED RS | DATE 03.07.98 | |
| SCALE AS SHOWN | CAD FILE CLZZ5495 | |

MCL/ZZ 5007

C

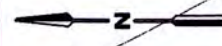
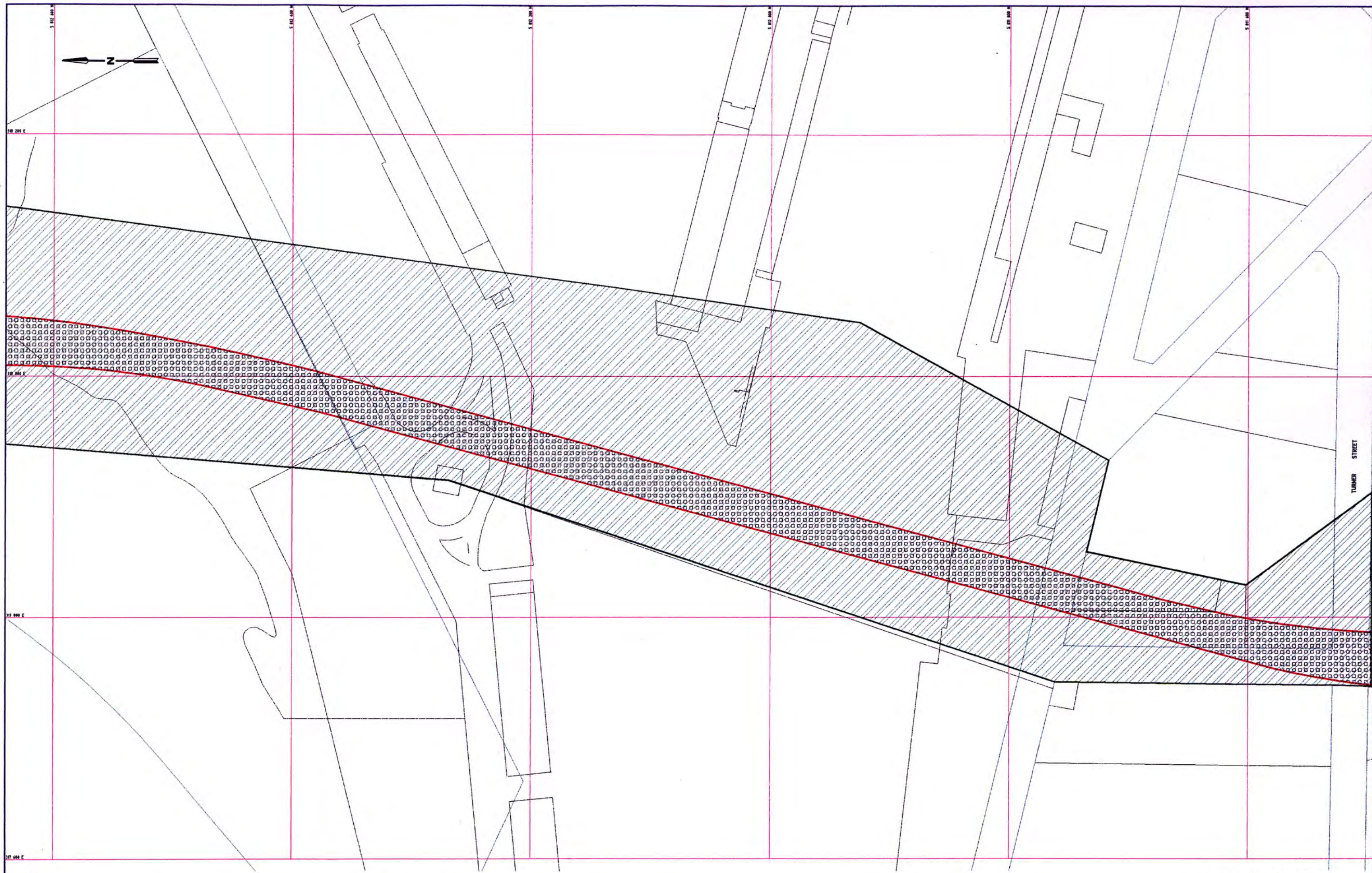

TURNER STREET

LEGEND

- FREEWAY
- MELBOURNE CITY LINK
- PROHIBITED AREA FOR ADVERTISING SKINS
- DOT REPRESENTS APPROXIMATE ADVERTISING SIGN LOCATIONS.

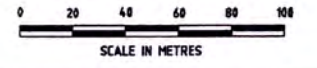

| REV | DATE | DESCRIPTION | DRN | APP | REV | DATE | DESCRIPTION | DRN | APP | REV | DATE | DESCRIPTION | DRN | APP | REV | DATE | DESCRIPTION |
|-----|----------|--|-----|-----|-----|------|-------------|-----|-----|-----|------|-------------|-----|-----|-----|------|-------------|
| 1 | 03.07.98 | ISSUED FOR INFORMATION | | | | | | | | | | | | | | | |
| 2 | 29.08.98 | PROJECT BOUNDARY REVISED & HATCHED AREAS REVISED | | | | | | | | | | | | | | | |



| | | |
|----------|------------------|----------|
| DESIGNER | DESIGN PARAMETER | SCALE |
| DRN | APP | DATE |
| REP | LPP | 03.07.98 |
| CHECKED | NS | CLZ3905 |
| SCALE | AS SHOWN | |

MELBOURNE CITY LINK PROJECT
CITY LINK
ADVERTISING SCHEDULE
SHEET 4 OF 14

MCL/ZZ 5008

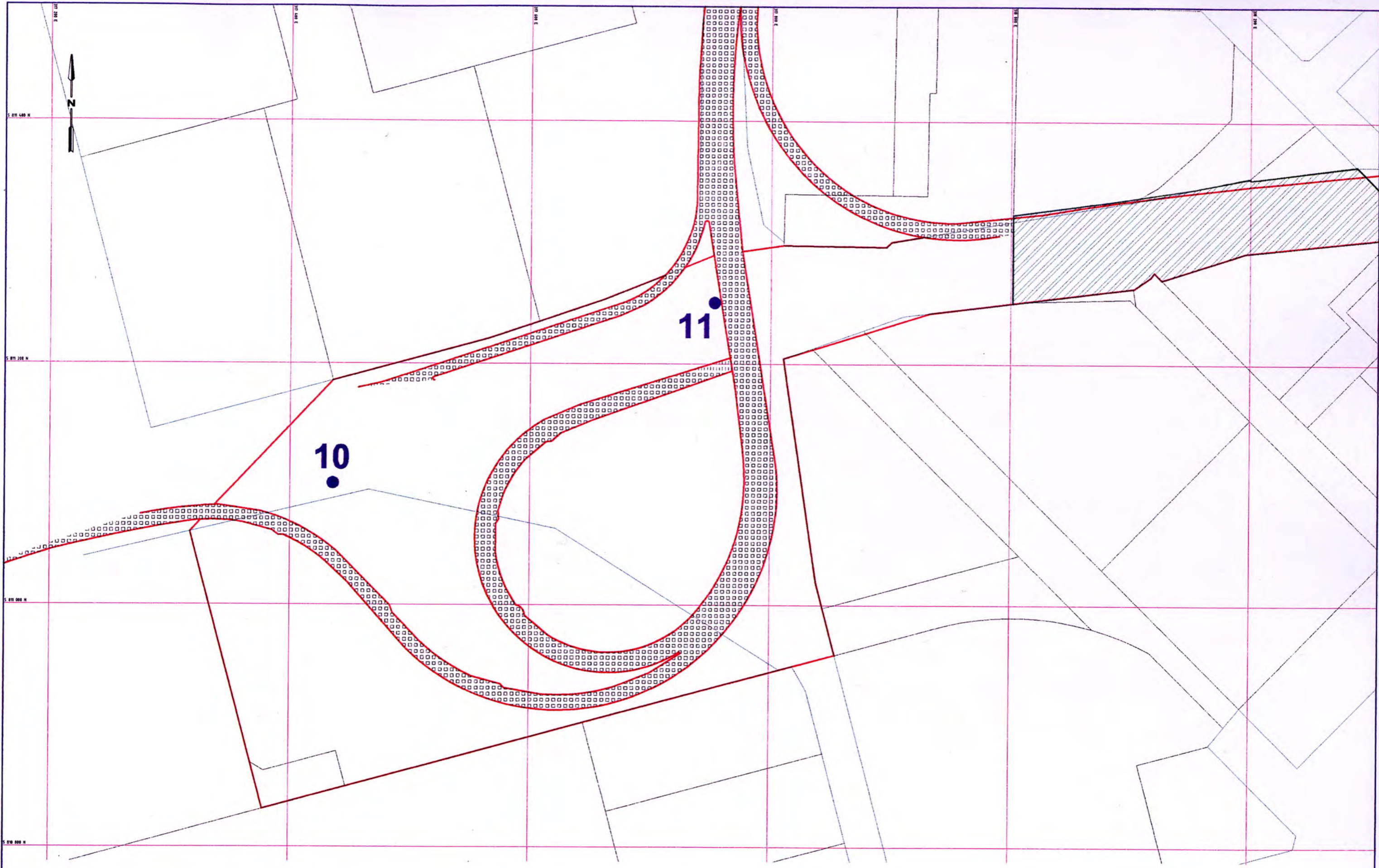

LEGEND

- FREEWAY
- MELBOURNE CITY LINK
- PROHIBITED AREA FOR ADVERTISING SIGNS
- DOT REPRESENTS APPROXIMATE ADVERTISING SIGN LOCATIONS.

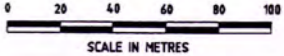

| REV | DATE | DESCRIPTION | DESIGNED | CHECKED | DATE | DESCRIPTION | DESIGNED | CHECKED | DATE | DESCRIPTION | DESIGNED | CHECKED | DATE |
|-----|----------|--|----------|---------|------|-------------|----------|---------|------|-------------|----------|---------|------|
| 8 | 20.08.98 | PROJECT BOUNDARY REMOVED & HATCHED AREAS REVISED | | RPL/LPF | | | | | | | | | |
| | | | | | | | | | | | | | |
| | | | | | | | | | | | | | |
| | | | | | | | | | | | | | |
| | | | | | | | | | | | | | |

TRANSFIELD

OBAYASHI

Transfield-Obayashi Joint Venture

| DESIGN | DESIGN PURPOSES | TITLE | | | | | | | | | | | | |
|--|-----------------|--------------------------------|-----|-----|---------|------|----|----------|-------|----------|----------|----------|--|--|
| <table border="1" style="width: 100%; border-collapse: collapse;"> <tr> <td>DRAWN</td> <td>APPROVED</td> </tr> <tr> <td>RGP</td> <td>LPF</td> </tr> <tr> <td>CHECKED</td> <td>DATE</td> </tr> <tr> <td>MS</td> <td>03.07.98</td> </tr> <tr> <td>SCALE</td> <td>CAD FILE</td> </tr> <tr> <td>AS SHOWN</td> <td>CL225005</td> </tr> </table> | DRAWN | APPROVED | RGP | LPF | CHECKED | DATE | MS | 03.07.98 | SCALE | CAD FILE | AS SHOWN | CL225005 | | <p>MELBOURNE CITY LINK PROJECT</p> <p>CITY LINK</p> <p>ADVERTISING SCHEDULE</p> <p>SHEET 5 OF 14</p> |
| DRAWN | APPROVED | | | | | | | | | | | | | |
| RGP | LPF | | | | | | | | | | | | | |
| CHECKED | DATE | | | | | | | | | | | | | |
| MS | 03.07.98 | | | | | | | | | | | | | |
| SCALE | CAD FILE | | | | | | | | | | | | | |
| AS SHOWN | CL225005 | | | | | | | | | | | | | |
| | | DRAWING NO: MCL/ZZ 5009 | | | | | | | | | | | | |

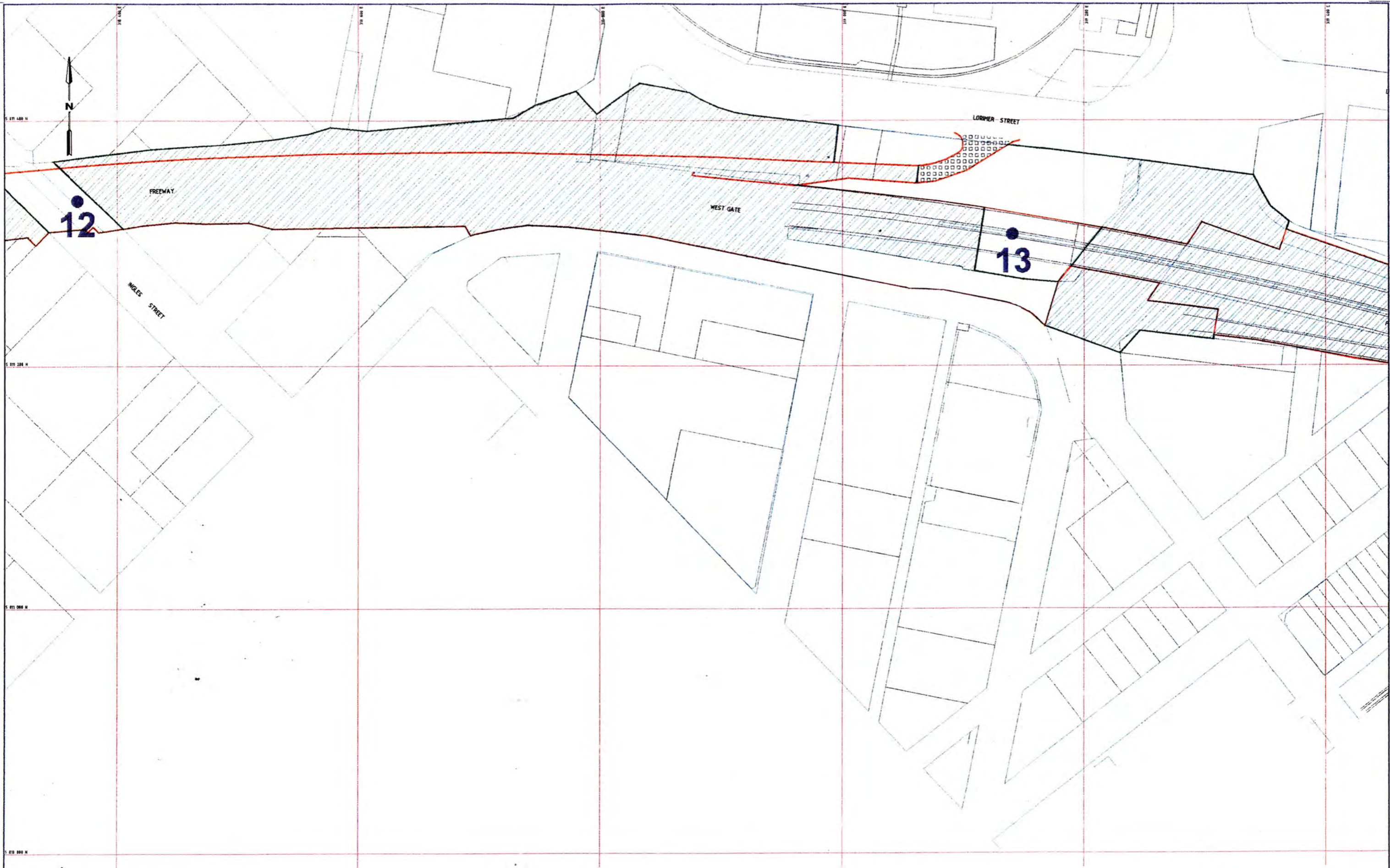

LEGEND

- FREEWAY
- MELBOURNE CITY LINK
- PROHIBITED AREA FOR ADVERTISING SIGNS
- DOT REPRESENTS APPROXIMATE ADVERTISING SIGN LOCATIONS.

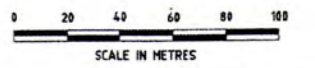

| REV | DATE | DESCRIPTION | DRN | APP | REV | DATE | DESCRIPTION | DRN | APP | REV | DATE | DESCRIPTION | DRN | APP | REV | DATE | DESCRIPTION |
|-----|----------|---|-----|-----|-----|------|-------------|-----|-----|-----|------|-------------|-----|-----|-----|------|-------------|
| A | 05.07.98 | ISSUED FOR INFORMATION | | | | | | | | | | | | | | | |
| B | 30.07.98 | PROHIBITED AREAS & ADVERTISING SIGN NO.'S REVISED | | | | | | | | | | | | | | | |
| C | 28.08.98 | PROJECT BOUNDARY REVISED & MATCHED AREAS REVISED | | | | | | | | | | | | | | | |



| | | |
|----------|---------------|-------------|
| DESIGN | DESIGN NUMBER | TITLE |
| DRN | APP | |
| CHKD | DATE | |
| SCALE | CAS FILE | DESIGNED BY |
| AS SHOWN | CL22595 | MCL/ZZ 5010 |

MELBOURNE CITY LINK PROJECT
CITY LINK
ADVERTISING SCHEDULE
SHEET 6 OF 14

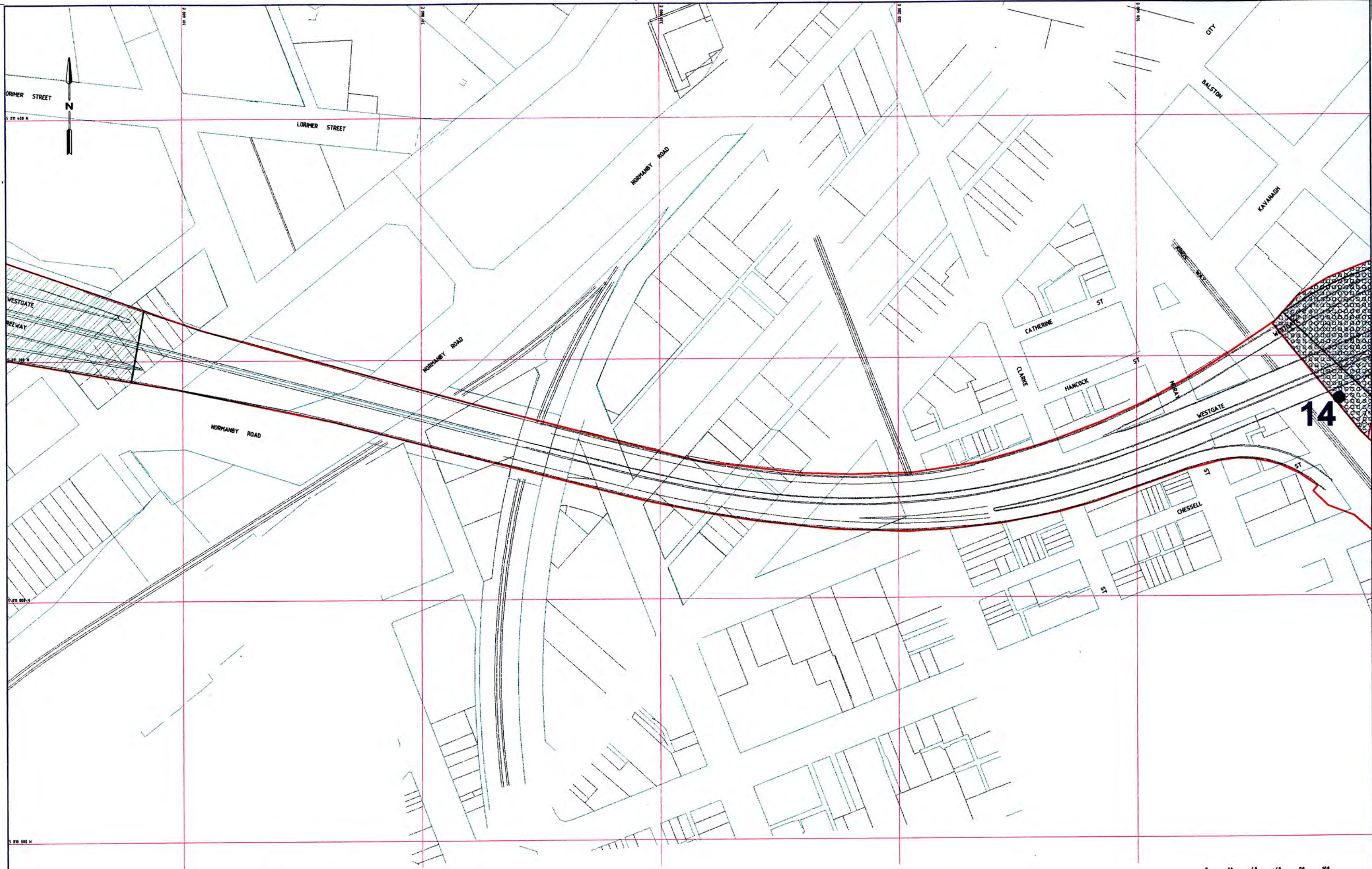

LEGEND

- FREEWAY
- MELBOURNE CITY LINK
- PROHIBITED AREA FOR ADVERTISING SIGNS
- DOT REPRESENTS APPROXIMATE ADVERTISING SIGN LOCATIONS.

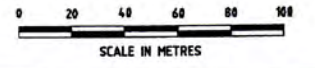

| REV | DATE | DESCRIPTION | BY | APP | REV | DATE | DESCRIPTION | BY | APP | REV | DATE | DESCRIPTION | BY | APP | REV | DATE | DESCRIPTION |
|-----|----------|---|----|-----|-----|------|-------------|----|-----|-----|------|-------------|----|-----|-----|------|-------------|
| A | 03.07.98 | ISSUED FOR INFORMATION | | | | | | | | | | | | | | | |
| B | 31.07.98 | PROHIBITED AREAS & ADVERTISING SIGN NO.'S REVISED | | | | | | | | | | | | | | | |
| C | 28.08.98 | PROJECT BOUNDARY REVISED & WATCHED AREAS REVISED | | | | | | | | | | | | | | | |



| | | |
|----------|---------------|-------------|
| DESIGN | DESIGN NUMBER | FILE |
| DRAWN | APPROVED | |
| CHECKED | DATE | |
| SCALE | CAD FILE | ISSUED BY |
| AS SHOWN | CLZ25495 | MCL/ZZ 5011 |

MELBOURNE CITY LINK PROJECT
CITY LINK
ADVERTISING SCHEDULE
SHEET 7 OF 14

C

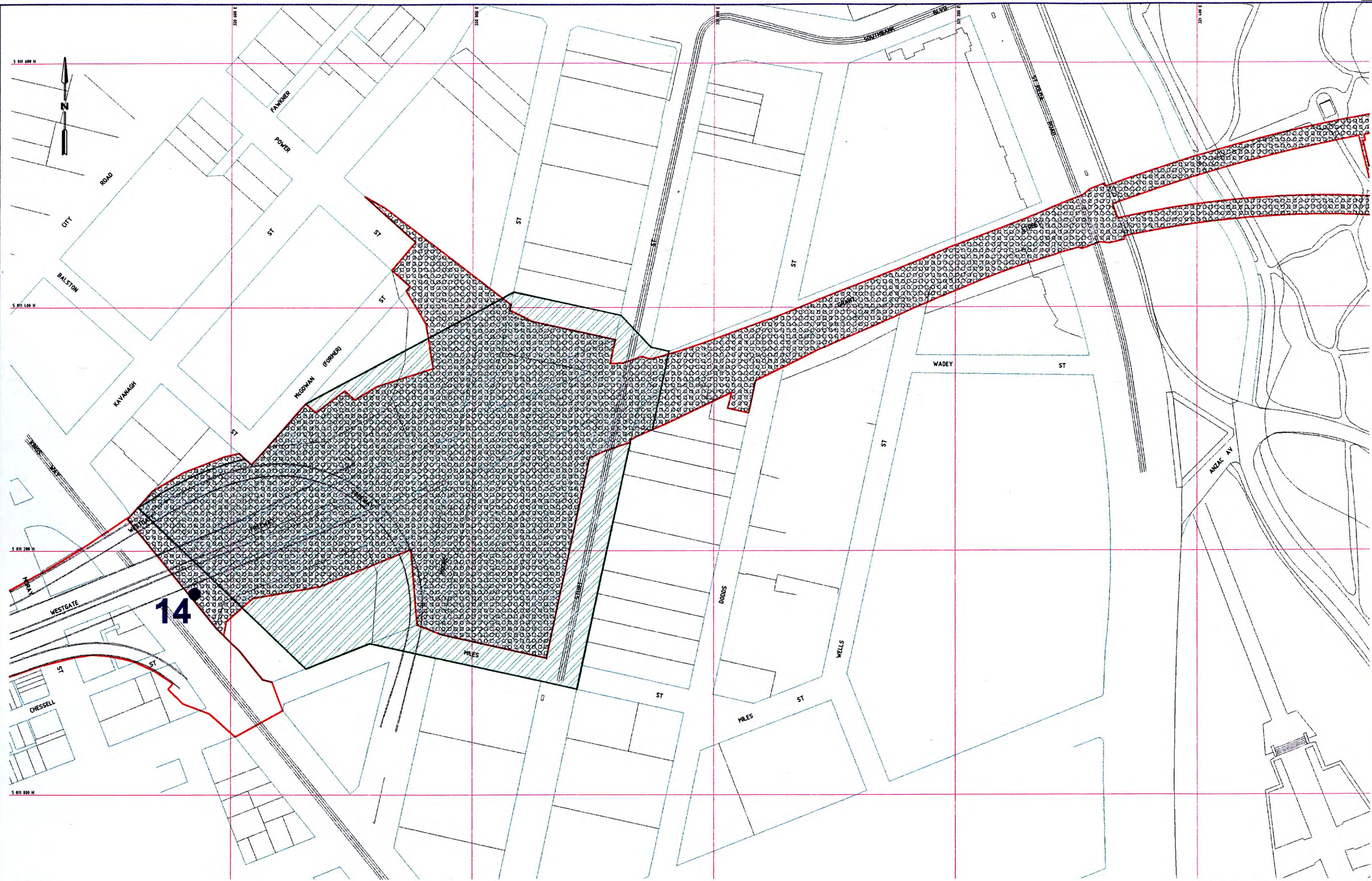

LEGEND

FREEWAY
 MELBOURNE CITY LINK
 PROHIBITED AREA FOR ADVERTISING SIGNS
● DOT REPRESENTS APPROXIMATE ADVERTISING SIGN LOCATIONS.

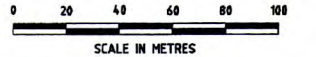

| REV | DATE | DESCRIPTION | DN | APP | REV | DATE | DESCRIPTION | DN | APP | REV | DATE | DESCRIPTION | DN | APP | REV | DATE | DESCRIPTION |
|-----|----------|---|-----|-----|-----|------|-------------|----|-----|-----|------|-------------|----|-----|-----|------|-------------|
| A | 03.07.98 | ISSUED FOR INFORMATION | | | | | | | | | | | | | | | |
| B | 31.07.98 | PROHIBITED AREAS & ADVERTISING SIGN NO.'S REVISED | RSP | LPP | | | | | | | | | | | | | |
| C | 29.08.98 | PROJECT BOUNDARY REMOVED & HATCHED AREAS REVISED | RSP | LPP | | | | | | | | | | | | | |



| DESIGN | DESIGN MANAGER | TITLE |
|----------|----------------|--------------------------------|
| RGP | LPP | MELBOURNE CITY LINK PROJECT |
| MS | MS | CITY LINK ADVERTISING SCHEDULE |
| AS SHOWN | CL225405 | SHEET 8 OF 14 |

MELBOURNE CITY LINK PROJECT
CITY LINK
ADVERTISING SCHEDULE
SHEET 8 OF 14

DRAWING NO: **MCL/ZZ 5012**

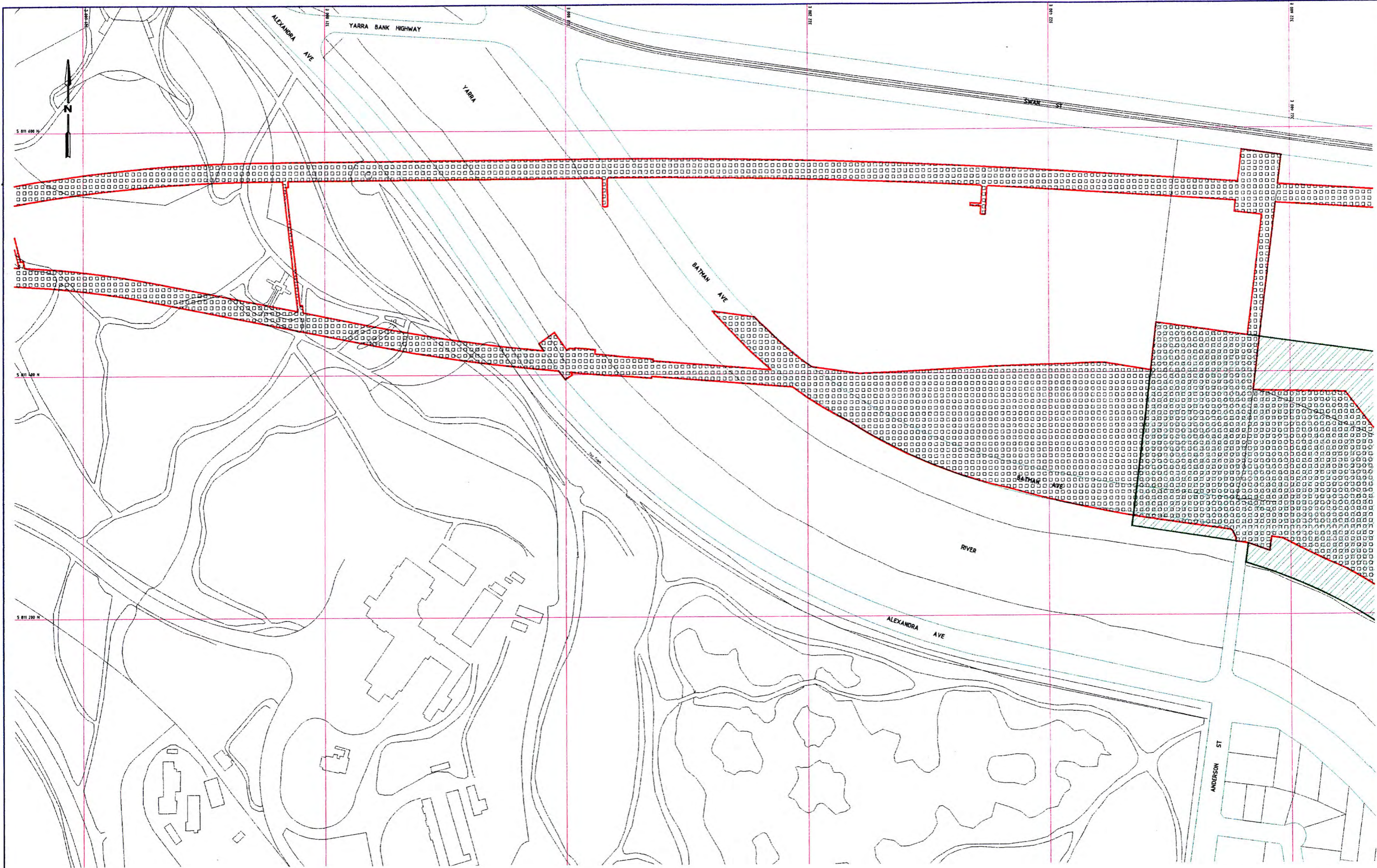

LEGEND

- FREEWAY
- MELBOURNE CITY LINK
- PROHIBITED AREA FOR ADVERTISING SIGNS
- DOT REPRESENTS APPROXIMATE ADVERTISING SIGN LOCATIONS.

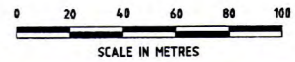

| REV | DATE | DESCRIPTION | DRN | APP | REV | DATE | DESCRIPTION | DRN | APP | REV | DATE | DESCRIPTION | DRN | APP | DRAWING NO. | REFERENCE DRAWINGS |
|-----|----------|--|-----|-----|-----|------|-------------|-----|-----|-----|------|-------------|-----|-----|-------------|--------------------|
| | | | | | | | | | | | | | | | | |
| A | 03.07.98 | ISSUED FOR INFORMATION | | | | | | | | | | | | | | |
| B | 26.08.98 | PROJECT BOUNDARY REMOVED & HATCHED AREAS REVISED | | | | | | | | | | | | | | |



| | |
|----------|---------------|
| DESIGN | DESIGN NUMBER |
| CHECKED | APPROVED |
| DATE | |
| SCALE | CAD FILE |
| AS SHOWN | CLZ25005 |

MELBOURNE CITY LINK PROJECT
CITY LINK
ADVERTISING SCHEDULE
SHEET 9 OF 14

DRAWN BY: **MCL/ZZ 5013**



LEGEND

- FREEWAY
- MELBOURNE CITY LINK
- PROHIBITED AREA FOR ADVERTISING SIGNS
- DOT REPRESENTS APPROXIMATE ADVERTISING SIGN LOCATIONS.



| REV | DATE | DESCRIPTION | DRN | APP | REV | DATE | DESCRIPTION | DRN | APP | REV | DATE | DESCRIPTION | DRN | APP | REV | DATE | DESCRIPTION |
|-----|----------|--|-----|-----|-----|------|-------------|-----|-----|-----|------|-------------|-----|-----|-----|------|-------------|
| A | 03.07.98 | ISSUED FOR INFORMATION | | | | | | | | | | | | | | | |
| B | 28.08.98 | PROJECT BOUNDARY REMOVED & HATCHED AREAS REVISED | | | | | | | | | | | | | | | |



| | | |
|--------|----------------|----------|
| DESIGN | DESIGN MANAGER | TITLE |
| DRN | APP | |
| CHEK | NS | 03.07.98 |
| SCALE | AS SHOWN | CLZ25005 |

MELBOURNE CITY LINK PROJECT
CITY LINK
ADVERTISING SCHEDULE
SHEET 10 OF 14

MCL/ZZ 5014

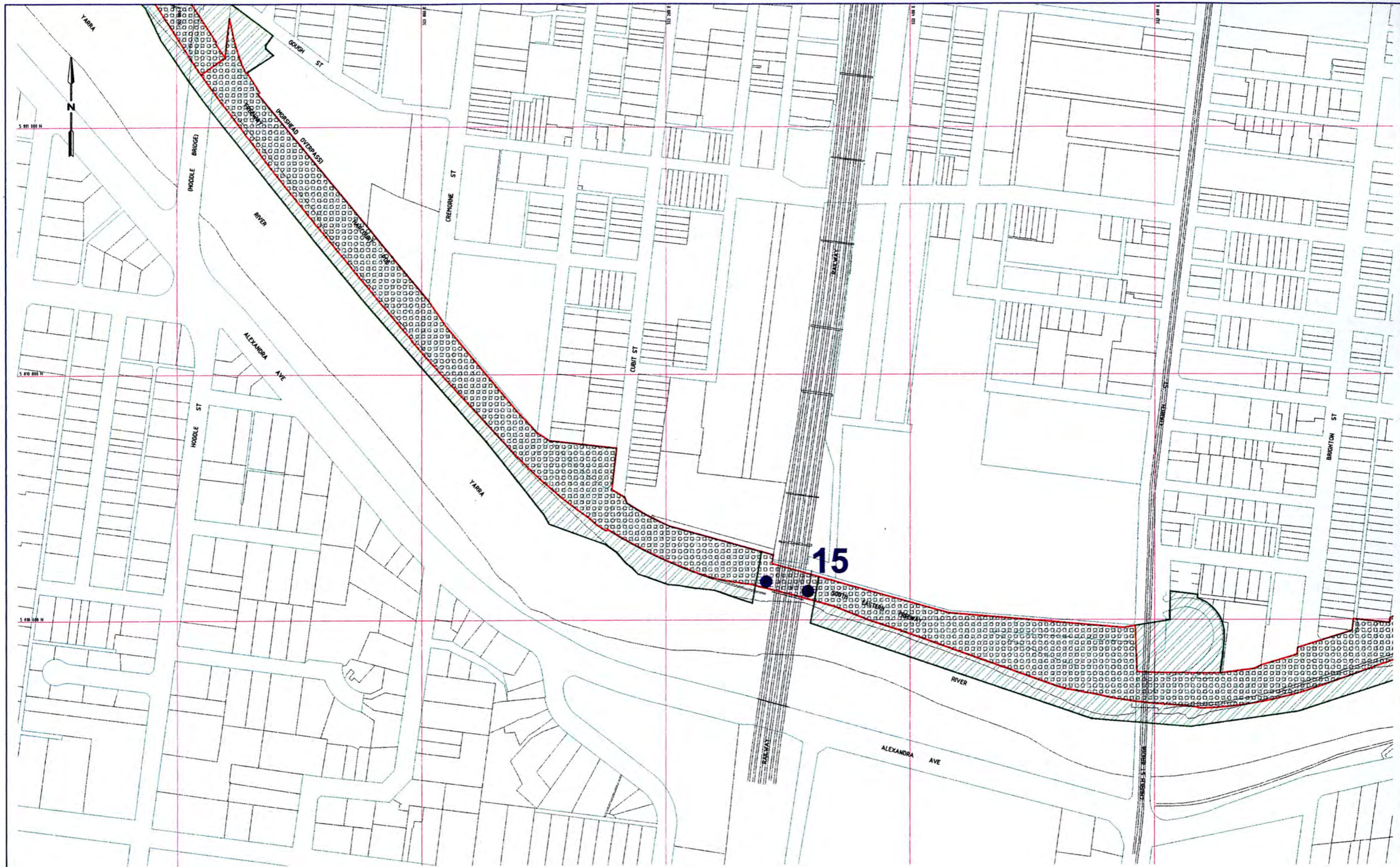

LEGEND

- FREEWAY
- MELBOURNE CITY LINK
- PROHIBITED AREA FOR ADVERTISING SIGNS
- DOT REPRESENTS APPROXIMATE ADVERTISING SIGN LOCATIONS.

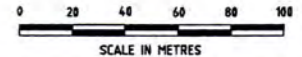

| REV | DATE | DESCRIPTION | DRN | APP | REV | DATE | DESCRIPTION | DRN | APP | REV | DATE | DESCRIPTION | DRN | APP | REV | DATE | DESCRIPTION |
|-----|----------|---|-----|-----|-----|------|-------------|-----|-----|-----|------|-------------|-----|-----|-----|------|-------------|
| A | 03.07.18 | ISSUED FOR INFORMATION | | | | | | | | | | | | | | | |
| B | 31.07.18 | PROHIBITED AREAS & ADVERTISING SIGN NO.'S REVISED | | | | | | | | | | | | | | | |
| C | 29.08.18 | PROJECT BOUNDARY REMOVED & MATCHED AREAS REVISED | | | | | | | | | | | | | | | |

TRANSFIELD

OBAYASHI

Transfield-Obayashi Joint Venture

| DESIGN | DESIGN MANAGER | FILE |
|----------|----------------|-------------|
| DRN | APP | |
| REV | REV | |
| DATE | DATE | |
| SCALE | CAD FILE | DRAWN BY |
| AS SHOWN | CLZ25065 | MCL/ZZ 5015 |

MELBOURNE CITY LINK PROJECT
CITY LINK
ADVERTISING SCHEDULE
SHEET 11 OF 14

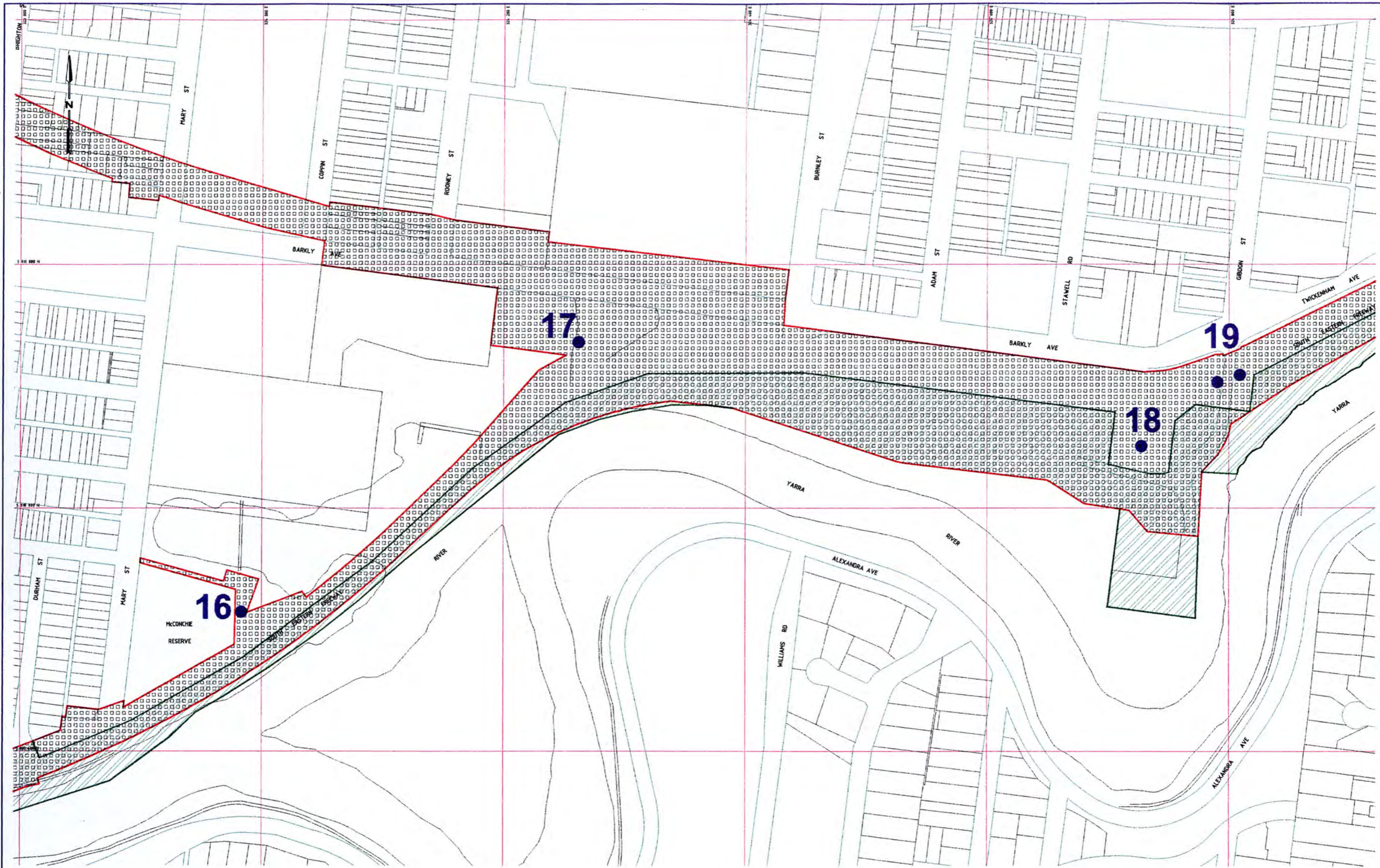

LEGEND

- FREEWAY
- MELBOURNE CITY LINK
- PROHIBITED AREA FOR ADVERTISING SIGNS
- DOT REPRESENTS APPROXIMATE ADVERTISING SIGN LOCATIONS.

| REV | DATE | DESCRIPTION | BY | APP | REV | DATE | DESCRIPTION | BY | APP | REV | DATE | DESCRIPTION | BY | APP | REV | DATE | DESCRIPTION |
|-----|----------|---|----|-----|-----|------|-------------|----|-----|-----|------|-------------|----|-----|-----|------|-------------|
| A | 23.07.18 | ISSUED FOR INFORMATION | | | | | | | | | | | | | | | |
| B | 31.07.18 | PROHIBITED AREAS & ADVERTISING SIGN NO.'S REVISED | | | | | | | | | | | | | | | |
| C | 28.08.18 | PROJECT BOUNDARY REMOVED & HATCHED AREAS REVISED | | | | | | | | | | | | | | | |

Transfield

Obayashi

Transfield-Obayashi Joint Venture

| | | |
|----------|---------------|--------------|
| DESIGN | DESIGN NUMBER | TITLE |
| DRAWN | APPROVED | |
| CHECKED | DATE | |
| SCALE | CAD FILE | REVISION NO. |
| AS SHOWN | CL225005 | MCL/ZZ 5016 |

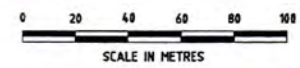

MELBOURNE CITY LINK PROJECT
CITY LINK
ADVERTISING SCHEDULE
SHEET 12 OF 14

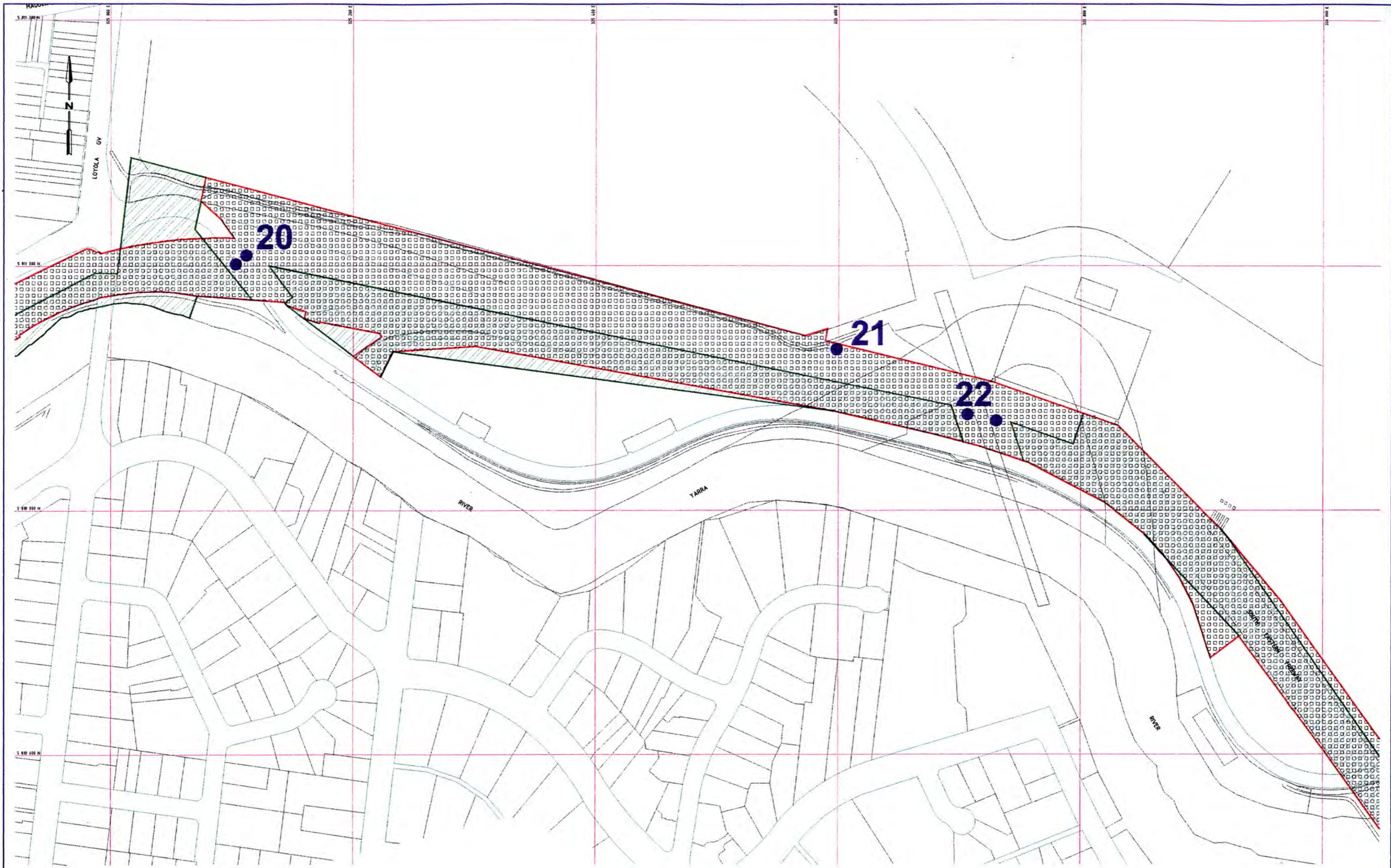

LEGEND

- FREEWAY
- MELBOURNE CITY LINK
- PROHIBITED AREA FOR ADVERTISING SIGNS
- DOT REPRESENTS APPROXIMATE ADVERTISING SIGN LOCATIONS.

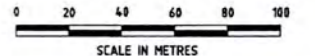

| REV | DATE | DESCRIPTION | BY | APP | REV | DATE | DESCRIPTION | BY | APP | REV | DATE | DESCRIPTION | BY | APP | REV | DATE | DESCRIPTION |
|-----|----------|---|----|-----|-----|------|-------------|----|-----|-----|------|-------------|----|-----|-----|------|-------------|
| A | 23.07.98 | ISSUED FOR INFORMATION | | | | | | | | | | | | | | | |
| B | 31.07.98 | PROHIBITED AREAS & ADVERTISING SIGN NO.'S REVISED | | | | | | | | | | | | | | | |
| C | 28.08.98 | PROJECT BOUNDARY REMOVED & HATCHED AREAS REVISED | | | | | | | | | | | | | | | |

TRANSFIELD

OBAYASHI

Transfield-Obayashi Joint Venture

| | |
|----------|--|
| OWNER | TRANSFIELD CITY LTD & OBAYASHI CORPORATION |
| DESIGNER | TRANSFIELD |
| DATE | 23.07.98 |
| SCALE | AS SHOWN |

| | |
|--------------|--------------------------------|
| PROJECT NAME | MELBOURNE CITY LINK PROJECT |
| SUBJECT | CITY LINK ADVERTISING SCHEDULE |
| SHEET | SHEET 13 OF 14 |
| DRAWING NO. | MCL/ZZ 5017 |

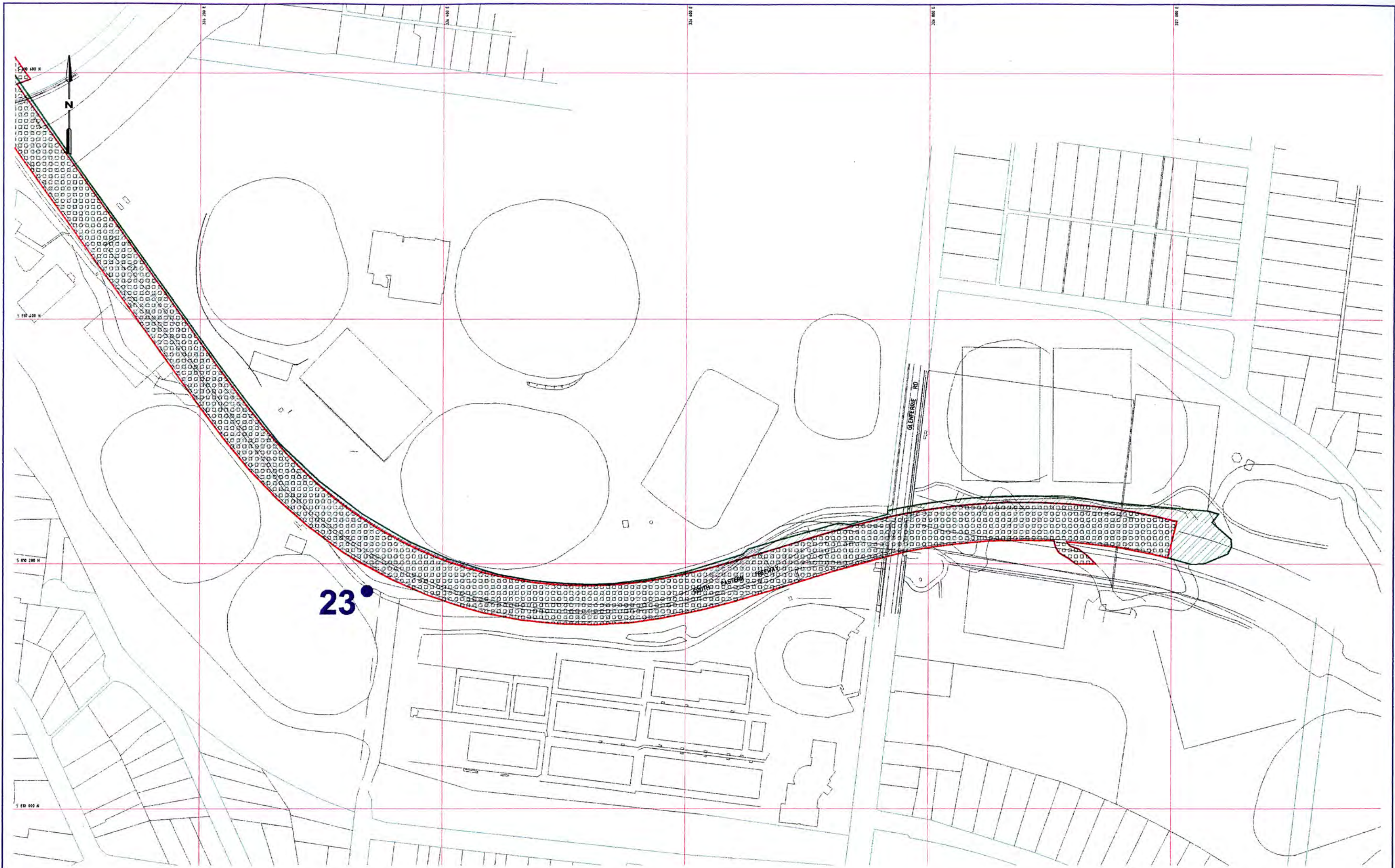

LEGEND

- FREEWAY
- MELBOURNE CITY LINK
- PROHIBITED AREA FOR ADVERTISING SIGNS
- DOT REPRESENTS APPROXIMATE ADVERTISING SIGN LOCATIONS.

| REV | DATE | DESCRIPTION | DRN | APP | REV | DATE | DESCRIPTION | DRN | APP | REV | DATE | DESCRIPTION | DRN | APP | REV | DATE | DESCRIPTION |
|-----|----------|---|-----|-----|-----|------|-------------|-----|-----|-----|------|-------------|-----|-----|-----|------|-------------|
| A | 03.07.98 | ISSUED FOR INFORMATION | | | | | | | | | | | | | | | |
| B | 11.07.98 | PROHIBITED AREAS & ADVERTISING SIGN NO.'S REVISED | | | | | | | | | | | | | | | |
| C | 25.08.98 | PROJECT BOUNDARY REMOVED & WATCHED AREAS REVISED | | | | | | | | | | | | | | | |

Transfield-Obayashi Joint Venture

| DESIGN | DESIGN NUMBER | TITLE |
|----------|---------------|----------|
| DESIGNER | RGP | APPROVED |
| CHECKER | NS | DATE |
| SCALE | AS SHOWN | CLZ25085 |

MELBOURNE CITY LINK PROJECT
CITY LINK
ADVERTISING SCHEDULE
SHEET 14 OF 14

DRAWING NO: **MCL/ZZ 5018**